



COPPER FITTINGS

**BRAZING FITTINGS FOR USE WITH NZS 3501 COPPER PLUMBING TUBE,
AS/NZS 1571 OR AS 1432 COPPER PLUMBING TUBE AS INDICATED.**



HIGHFLO

COPPER FITTINGS SINCE 1958

CATALOGUE VERSION 24.1

ISSUED 15TH APRIL 2024

CONTENTS



ELBOWS

PAGES 4 & 5

90° ELBOWS

TIGHT RADIUS (SHORT) ELBOWS

45° ELBOWS

180° ELBOWS

TUBE EXPANDERS

PAGE 5

TUBE EXPANDERS TO SUIT NZS3501 & AS1432 TUBE

BENDS

PAGES 6 & 7

90° & 92.5° BENDS

45° BENDS

90° LONG BENDS

45° LONG BENDS

PRE-CROXED BENDS

PRE-CROXED CONNECTORS

BRANCH BENDS

TEES

PAGES 8 & 9

EQUAL TEES

REDUCING TEES

REDUCERS

PAGES 10 & 11

F/F SINGLE STEP REDUCERS

MULTISTEP (UNIVERSAL) REDUCERS

M/F SINGLE STEP REDUCERS

AS TO NZS CONVERSION REDUCERS

S TRAPS

PAGE 12

PLAIN COPPER & CHROME PLATED - SHORT AND LONG VERSIONS

P TRAPS

PAGE 13

PLAIN COPPER & CHROME PLATED - SHORT AND LONG VERSIONS

TRAP ACCESSORIES

PAGE 14

EXTENSIONS

TUNDISHES

TRAP (CAP) NUTS & BRAZING RINGS - BRASS & CHROME PLATED

FLANGES & GASKETS

PAGE 15

TABLE D

TABLE E

DIN (PN16)

ANSI 150

BLIND BACKING FLANGES

JUNCTIONS

PAGES 16 & 17

EQUAL AND REDUCING WITH 45° & 92.5° OPTIONS

MISCELLANEOUS

PAGES 18, 19 & 20

JOINERS (INC. AS TO NZ ADAPTORS) END CAPS TABLE I COMPLIANT FITTINGS

FLUSHPIPES IN PLAIN COPPER & CHROME PLATED

COMPLIANCE, WARRANTY PAGES 22, 23 & 24

TERMS & CONDITIONS

COMPLIANCE STATEMENT

UNDERTAKINGS, TERMS & CONDITIONS OF SALE

RETURNS POLICY

WARRANTY STATEMENT



KEY CONTACTS

IAN CARSON—MANAGING DIRECTOR

IAN HAS BEEN WITH HIGHFLO SINCE 2002 AND IS OUR 'HANDS ON' MANAGING DIRECTOR. HE IS EXTREMELY PROUD OF HIGHFLO'S LOCAL MANUFACTURING HERITAGE AND HAS WORKED HARD TO BOTH MAINTAIN AND BUILD THE RANGE OF PRODUCTS MADE HERE IN OUR FACTORY IN LOWER HUTT, NZ.

THROUGH IAN'S LEADERSHIP HIGHFLO HAS ALSO PARTNERED WITH LEADING OVERSEAS SPECIALISTS, GIVING HIGHFLO ACCESS TO BOTH HIGH VOLUME - PRICE SENSITIVE PRODUCTS AND SPECIALITY ITEMS AS WELL.

WHY CHOOSE HIGHFLO IN IAN'S OPINION? "NO OTHER COPPER PLUMBING FITTING WHOLESALER IN NZ CAN SUPPORT THEIR CUSTOMERS WITH THE PRODUCT RANGE, QUALITY, AND SERVICE STANDARD OF HIGHFLO. WITHIN SPECIFICATION, ON TIME & AT A FAIR PRICE IS OUR MOTTO"

ONE OF THE THINGS IAN IS MOST PROUD OF, IS THAT THROUGH THE ON-GOING SUPPORT OF OUR CUSTOMERS, AND THE GROWTH THAT HAS ALLOWED HIGHFLO TO MAINTAIN OVER THE LAST TWO DECADES, THERE HAS ALSO BEEN A MANAGEMENT LED DRIVE TO ENSURE WE "GIVE BACK" TO THE COMMUNITY WE OPERATE WITHIN.

TO THIS EXTENT HIGHFLO HAS BEEN A COMMUNITY PARTNER WITH THE LIFEFLIGHT TRUST SINCE 2005, SPONSORED THE SPECIAL CHILDREN'S CHRISTMAS PARTY SINCE 2012 AND THIS YEAR HIGHFLO HAS ALSO BEGUN A PARTNERSHIP WITH THE LOCAL FOODBANK WITH THE AIM TO SPONSOR APPROXIMATELY 750 READY MADE MEALS INTO THE HOMES OF THOSE IN NEED, IN OUR LOCAL COMMUNITY.



LYNETTE CARSON—FINANCIAL CONTROLLER

LYNETTE JOINED THE STAFF AT HIGHFLO IN 2010 AND IS OUR FINANCIAL CONTROLLER. LYNETTE FACILITATED THE TRANSITION TO 'CLOUD BASED' ACCOUNTING WHICH HAS LED TO GREAT IMPROVEMENT IN BOTH OUR OPERATIONAL EFFICIENCY AND OUR ABILITY TO BETTER SERVICE OUR CUSTOMERS. LYNETTE ALSO COVERS THE 'PACK AND DISPATCH' FROM TIME TO TIME, AND MAY WELL BE THE FRIENDLY VOICE WHO ANSWERS YOUR PHONE CALL. LYNETTE IS THE GRAND-DAUGHTER OF HIGHFLO'S CO-FOUNDER AND IS THE THIRD GENERATION OF FAMILY DIRECTORSHIP OF THE COMPANY.



IAN RAMSAY (RETIRED)

IAN RAMSAY HAS A LONG ASSOCIATION WITH HIGHFLO AS IT WAS HIS FATHER, A.J. RAMSAY, WHO CO-FOUNDED THE COMPANY, IN OTAKI, NZ, IN 1958. INITIALLY HIGHFLO MADE ONLY COPPER TRAPS, AND IAN IS ESPECIALLY PROUD TO SEE HOW THE PRODUCT RANGE HAS DEVELOPED OVER TIME. ALTHOUGH IAN HAS 'RETIRED' FROM HIS DAY-TO-DAY INVOLVEMENT HE STILL HAS AN ACTIVE INTEREST KEEPING UP TO DATE WITH NEW DEVELOPMENTS AND CHECKING IN FROM TIME TO TIME TO MAKE SURE WE ARE DOING A 'GOOD JOB'!



OFFICE: (04) 5700600
SALES: 0800 COPPER (0800 267737)
WEB: WWW.HIGHFLO.CO.NZ
EMAIL: ACCOUNTS@HIGHFLO.CO.NZ
SALES@HIGHFLO.CO.NZ

PHYSICAL: 403 HUTT ROAD
ALICETOWN
LOWER HUTT 5010
NEW ZEALAND

COPPER ELBOWS

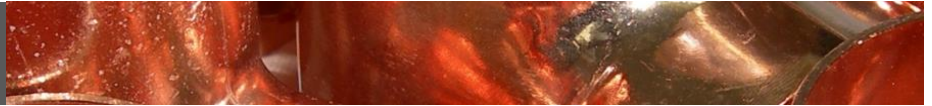

90° COPPER ELBOWS – EXPANDED BOTH ENDS

SIZE	CODE	RADIUS 'R'	DEPTH 'S'	LENGTH 'L'
10MM*	CE1090	10MM	5MM	15MM
*SUITS 9.52MM AS/NZS1571 TUBE				
15MM	CE1590	23MM	11MM	30MM
20MM	CE2090	27MM	12MM	42MM
25MM	CE2590	31MM	12MM	54MM
32MM	CE3290	37MM	15MM	62MM
40MM	CE4090	43MM	15MM	69MM
50MM	CE5090	60MM	12MM	79MM
65MM	CE6592	78MM	18MM	107MM
80MM	CE8092	110MM	23MM	125MM
100MM	CE10092	127MM	25MM	165MM
125MM^	CE12590	187MM	20MM	188MM
^NO LONGER SUPPORTING AS3688—REMAINING STOCK ONLY.				
150MM	CE15090LR	212MM	50MM	262MM
200MM~	CE20090	300MM	28MM	300MM
~NO LONGER SUPPORTING AS3688—REMAINING STOCK ONLY				

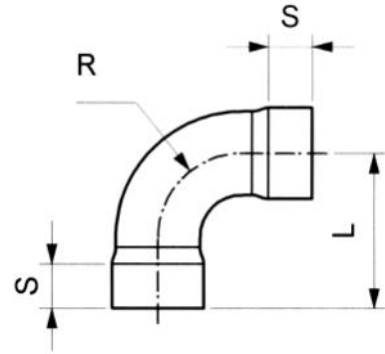

45° COPPER ELBOWS – EXPANDED BOTH ENDS

SIZE	CODE	RADIUS 'R'	DEPTH 'S'
15MM	CE1545	23MM	11MM
20MM	CE2045	27MM	12MM
25MM	CE2545	31MM	12MM
32MM	CE3245	37MM	15MM
40MM	CE4045	43MM	15MM
50MM	CE5045	60MM	12MM
65MM	CE6545	78MM	18MM
80MM	CE8045	110MM	23MM
100MM	CE10045	127MM	25MM
125MM^	CE12545	187MM	20MM
^NO LONGER SUPPORTING AS3688—REMAINING STOCK ONLY			
150MM	CE15045	142MM	45MM
200MM*	CE20045	300MM	28MM
*NO LONGER SUPPORTING AS3688—REMAINING STOCK ONLY			

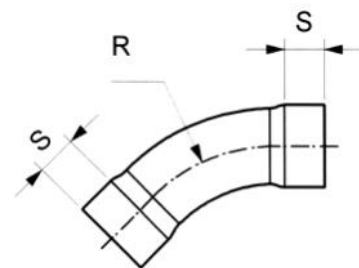



COPPER ELBOWS & TUBE EXPANDERS

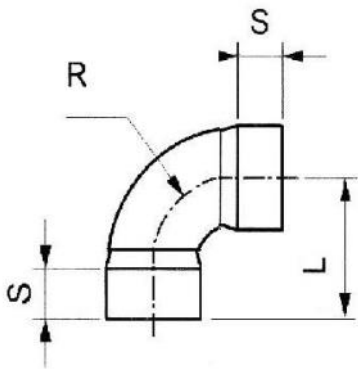

SHORT (TIGHT RADIUS) COPPER ELBOWS

SIZE	CODE	RADIUS 'R'	DEPTH 'S'	LENGTH 'L'
15MM	CE15S	13MM	10MM	20MM
20MM	CE20S	20MM	14MM	26MM
25MM	CE25S	25MM	15MM	35MM
150MM	CE150S	103MM	47MM	103MM

180° COPPER U ELBOWS EXPANDED BOTH ENDS

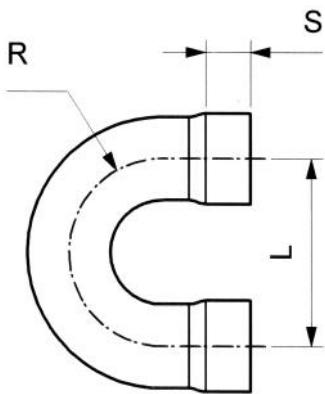

SIZE	CODE	RADIUS 'R'	DEPTH 'S'	LENGTH 'L'
15MM	CE15180	23MM	11MM	46MM
20MM	CE20180	27MM	12MM	54MM
25MM	CE25180	31MM	12MM	62MM
32MM [#]	CE32180	37MM	15MM	74MM
40MM [#]	CE40180	43MM	15MM	86MM
50MM [#]	CE50180	60MM	12MM	120MM
65MM [#]	CE65180	78MM	18MM	156MM
80MM [#]	CE80180	110MM	23MM	220MM
100MM [#]	CE100180	138MM	25MM	276MM

[#] MADE TO ORDER AND NON RETURNABLE

COPPER TUBE EXPANDER - NZS3501 & AS1432 - COLLETT TYPE

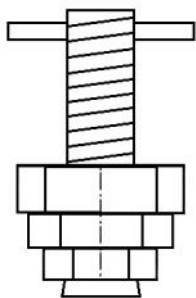

CODE	DESCRIPTION
EXP5040	TUBE EXPANDER FOR NZS3501 50MM & NZS3501 40MM
EXP65	TUBE EXPANDER FOR NZS3501 65MM
EXP10080	TUBE EXPANDER FOR NZS3501 TABLE II 100MM & 80MM
EXPNZ150AS125	TUBE EXPANDER FOR NZS3501 150MM & AS1432 125MM
EXPAS50AS40	TUBE EXPANDER FOR AS1432 50MM & AS1432 40MM
EXPAS65	TUBE EXPANDER FOR AS1432 65MM
EXPAS100AS80	TUBE EXPANDER FOR AS1432 100MM & AS1432 80MM
EXPAS200AS150	TUBE EXPANDER FOR AS1432 200MM & AS1432 150MM



COPPER BENDS



45° AND 90° COPPER LONG BENDS EXPANDED ONE END

SIZE	CODE	RADIUS 'R'	DEPTH 'S'
25MM	CB2545L	31MM	12MM

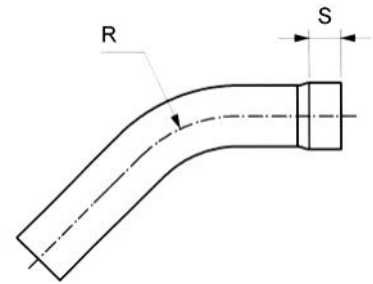

SIZE	CODE	RADIUS 'R'	DEPTH 'S'	LENGTH 'L'
15MM	CB1590L	23MM	11MM	64MM
20MM	CB2090L	27MM	12MM	65MM
25MM	CB2590L	31MM	12MM	80MM

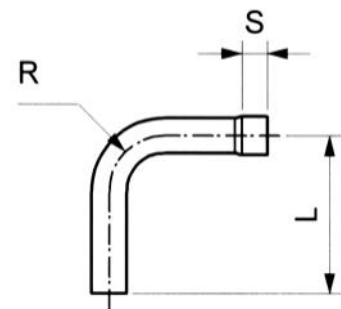

PRE-CROXED BSP TO COPPER BENDS

TUBE	CODE	SOCKET	BSP NUT	ANGLE
15MM	BCBSP15	15MM	1/2"	90°
20MM	BCBSP20	20MM	3/4"	90°

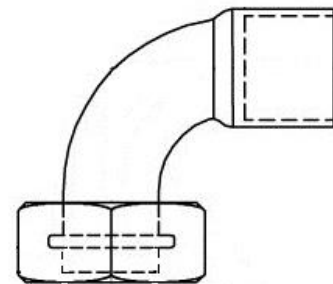

PRE-CROXED BSP TO COPPER STRAIGHT CONNECTORS

TUBE	CODE	SOCKET	BSP NUT
15MM	SCBSP15x1/2	15MM	1/2"
15MM	SCBSP15x3/4	15MM	3/4"
20MM	SCBSP20x3/4	20MM	3/4"

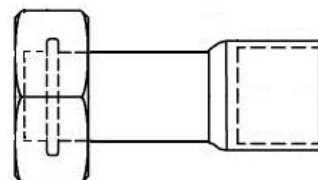

COPPER BENDS

45° COPPER BENDS – EXPANDED ONE END

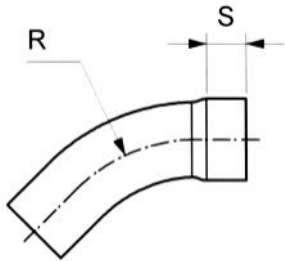

SIZE	CODE	RADIUS 'R'	DEPTH 'S'
15MM	CB1545	23MM	11MM
20MM	CB2045	27MM	12MM
25MM	CB2545	31MM	12MM
32MM	CB3245	37MM	15MM
40MM	CB4045	43MM	15MM
50MM	CB5045	60MM	12MM
65MM	CB6545	78MM	18MM
80MM	CB8045	110MM	23MM
100MM	CB10045	127MM	25MM

90° / 92.5° COPPER BENDS – EXPANDED ONE END

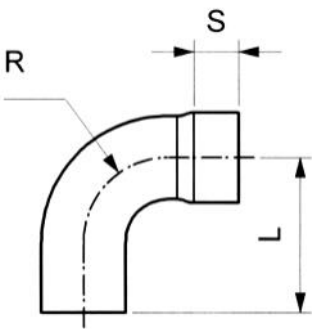

SIZE	CODE	RADIUS 'R'	DEPTH 'S'	LENGTH 'L'
15MM	CB1590	23MM	11MM	48MM
20MM	CB2090	27MM	12MM	60MM
25MM	CB2590	31MM	12MM	64MM
32MM	CB3290	37MM	15MM	62MM
40MM	CB4090	43MM	15MM	69MM
50MM	CB5090	60MM	12MM	79MM
65MM	CB6592	78MM	18MM	107MM
80MM	CB8092	110MM	23MM	125MM
100MM	CB10092	127MM	25MM	165MM

COPPER BRANCH BENDS – EXPANDED ONE END

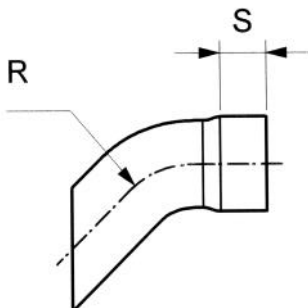

SIZE	CODE	RADIUS 'R'	DEPTH 'S'
15MM	CB15BB	23MM	11MM
20MM	CB20BB	27MM	12MM
25MM	CB25BB	31MM	12MM
32MM	CB32BB	37MM	15MM
40MM	CB40BB	43MM	15MM
50MM	CB50BB	60MM	12MM
65MM	CB65BB	78MM	18MM
80MM	CB80BB	110MM	23MM
100MM	CB100BB	127MM	25MM

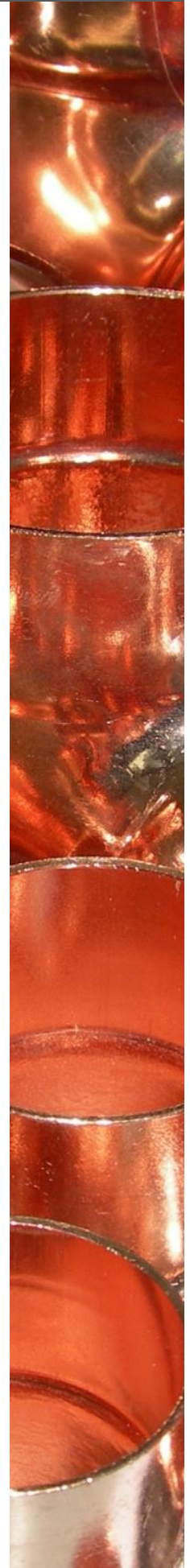

COPPER TEES—REDUCING

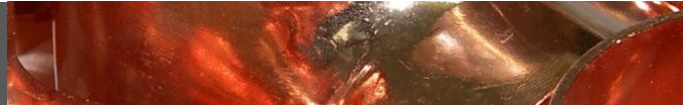

REDUCING BRANCH COPPER TEE—DIMENSIONS S1 x S2 x S3

SIZE	CODE	S1 'LEFT'	S2 'RIGHT'	S3 'BRANCH'
15x15x10*	CTR151510	15MM	15MM	10MM
*SUITS 9.52MM AS/NZS1571 TUBE				
20x20x15	CTR202015	20MM	20MM	15MM
25x25x15	CTR252515	25MM	25MM	15MM
25x25x20	CTR252520	25MM	25MM	20MM
32x32x15	CTR323215	32MM	32MM	15MM
32x32x20	CTR323220	32MM	32MM	20MM
32x32x25	CTR323225	32MM	32MM	25MM
40x40x20	CTR404020	40MM	40MM	20MM
40x40x25	CTR404025	40MM	40MM	25MM
40x40x32	CTR404032	40MM	40MM	32MM
50x50x20	CTR505020	50MM	50MM	20MM
50x50x25	CTR505025	50MM	50MM	25MM
50x50x32	CTR505032	50MM	50MM	32MM
50x50x40	CTR505040	50MM	50MM	40MM
65x65x32	CTR656532	65MM	65MM	32MM
65x65x40	CTR656540	65MM	65MM	40MM
65x65x50	CTR656550	65MM	65MM	50MM
80x80x40	CTR808040	80MM	80MM	40MM
80x80x50	CTR808050	80MM	80MM	50MM
80x80x65	CTR808065	80MM	80MM	65MM
100x100x50	CTR10010050	100MM	100MM	50MM
100x100x65	CTR10010065	100MM	100MM	65MM
100x100x80	CTR10010080	100MM	100MM	80MM

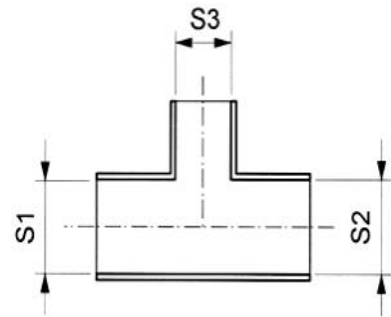

REDUCING IN-LINE COPPER TEE—DIMENSIONS S1 x S2 x S3

SIZE	CODE	S1 'LEFT'	S2 'RIGHT'	S3 'BRANCH'
15x15x20	CTR151520	15MM	15MM	20MM
20x20x25	CTR202025	20MM	20MM	25MM
20x20x32	CTR202032	20MM	20MM	32MM
25x25x32	CTR252532	25MM	25MM	32MM

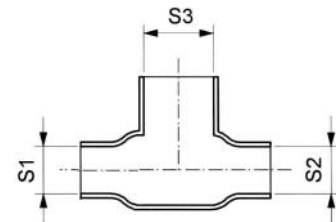

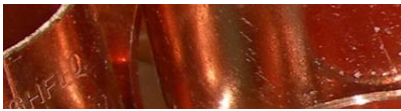

COPPER TEES—REDUCING & EQUAL

REDUCING BRANCH COPPER TEES—DIMENSIONS S1 x S2 x S3

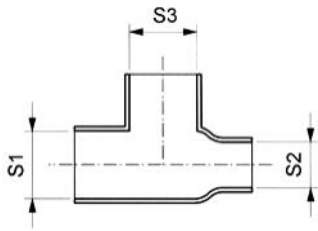

SIZE	CODE	S1 'LEFT'	S2 'RIGHT'	S3 'BRANCH'
20x15x20	CTR201520	20MM	15MM	20MM

REDUCING INLINE & BRANCH TEE—DIMENSIONS S1 x S2 x S3

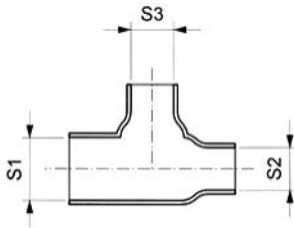

SIZE	CODE	S1 'LEFT'	S2 'RIGHT'	S3 'BRANCH'
20x15x15	CTR201515	20MM	15MM	15MM

MANY OTHER REDUCING TEE COMBINATIONS AVAILABLE
PLEASE CALL WITH YOUR REQUIREMENTS

COPPER TEES—EQUAL

EQUAL COPPER TEES—DIMENSIONS S1 x S2 x S3

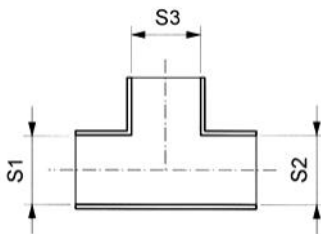

SIZE	CODE	S1 'LEFT'	S2 'RIGHT'	S3 'BRANCH'
10MM*	CTE10	10MM	10MM	10MM
*SUITS 9.52MM AS/NZS1571 TUBE				
15MM	CTE15	15MM	15MM	15MM
20MM	CTE20	20MM	20MM	20MM
25MM	CTE25	25MM	25MM	25MM
32MM	CTE32	32MM	32MM	32MM
40MM	CTE40	40MM	40MM	40MM
50MM	CTE50	50MM	50MM	50MM
65MM	CTE65	65MM	65MM	65MM
80MM	CTE80	80MM	80MM	80MM
100MM	CTE100	100MM	100MM	100MM
125MM^	CTE125	125MM	125MM	125MM
^NO LONGER SUPPORTING AS3688—REMAINING STOCK ONLY.				
150MM	CTE150	150MM	150MM	150MM
200MM~	CTE200	200MM	200MM	200MM

~NO LONGER SUPPORTING AS3688—REMAINING STOCK ONLY

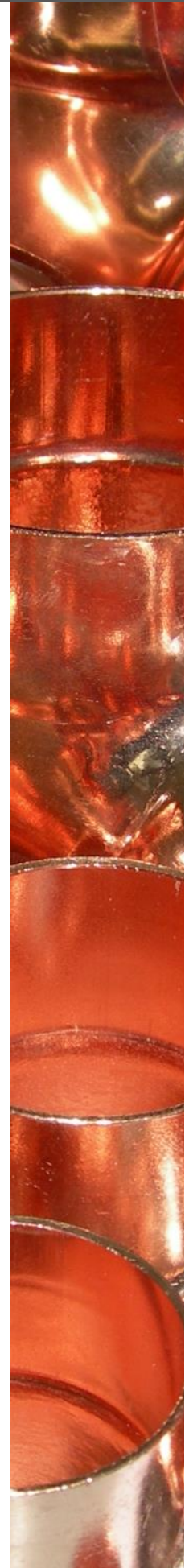

COPPER REDUCERS



SINGLE STEP M/F COPPER REDUCERS (BUSHINGS)

SIZE	CODE	SOCKET A 'MALE'	SOCKET B 'FEMALE'
15X10*	CR1510MF	15MM	10MM
	*SUITS 9.52MM AS/NZS1571 TUBE		
20X15	CR2015MF	20MM	15MM
25X15	CR2515MF	25MM	15MM
25X20	CR2520MF	25MM	20MM
32X20	CR3220MF	32MM	20MM
32X25	CR3225MF	32MM <td 25MM	
40X20	CR4020MF	40MM	20MM
40X25	CR4025MF	40MM	25MM
40X32	CR4032MF	40MM	32MM

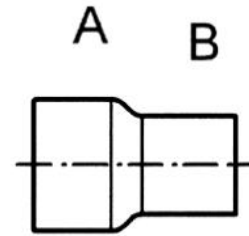

MULTI-STEP (UNIVERSAL) F/F COPPER REDUCERS

SIZE	CODE	SOCKET A	B	C	D	E
50x20	CSR5020	50MM	40MM	32MM	25MM	20MM
65x40	CSR6540	65MM	50MM	40MM		
80x40	CSR8040	80MM	65MM	50MM	40MM	
100x50	CSR10050	100MM	80MM	65MM	50MM	

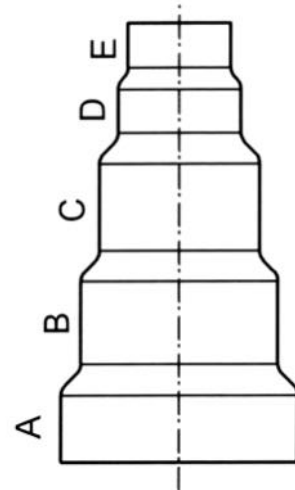

AS1432 TO NZS3501 (F/F & M/F OPTIONS) COPPER ADAPTORS

SIZE	CODE	SOCKET A	SOCKET B
125^x80	CRAS125NZ80	125MM^	80MM
125^x100	CRAS125NZ100	125MM^	100MM
150x125^	CRNZ150AS125	150MM	125MM^
200~x125^	CRAS200AS125	200MM~	125MM^
200~x150	CRAS200NZ150	200MM~	150MM

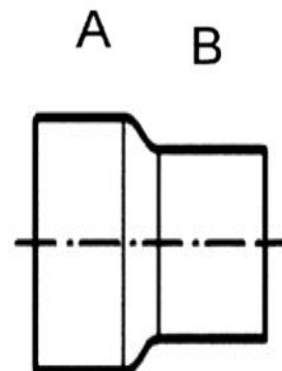

^NO LONGER SUPPORTING AS3688—REMAINING STOCK ONLY

~NO LONGER SUPPORTING AS3688—REMAINING STOCK ONLY

COPPER REDUCERS

SINGLE STEP F/F COPPER REDUCERS

SIZE	CODE	SOCKET A	SOCKET B
15x10*	CR1510	15MM	10MM
*SUITS 9.52MM AS/NZS1571 TUBE			
20x15	CR2015	20MM	15MM
25x15	CR2515	25MM	15MM
25x20	CR2520	25MM	20MM
32x15	CR3215	32MM	15MM
32x20	CR3220	32MM	20MM
32x25	CR3225	32MM	25MM
40x20	CR4020	40MM	20MM
40x25	CR4025	40MM <td 25MM	
40x32	CR4032	40MM	32MM
50x20	CR5020	50MM	20MM
50x25	CR5025	50MM	25MM
50x32	CR5032	50MM	32MM
50x40	CR5040	50MM	40MM
65x32	CR6532	65MM	32MM
65x40	CR6540	65MM	40MM
65x50	CR6550	65MM	50MM
80x40	CR8040	80MM	40MM
80x50	CR8050	80MM	50MM
80x65	CR8065	80MM	65MM
100x50	CR10050	100MM	50MM
100x65	CR10065	100MM	65MM
100x80	CR10080	100MM	80MM
150x100	CR150100	150MM	100MM

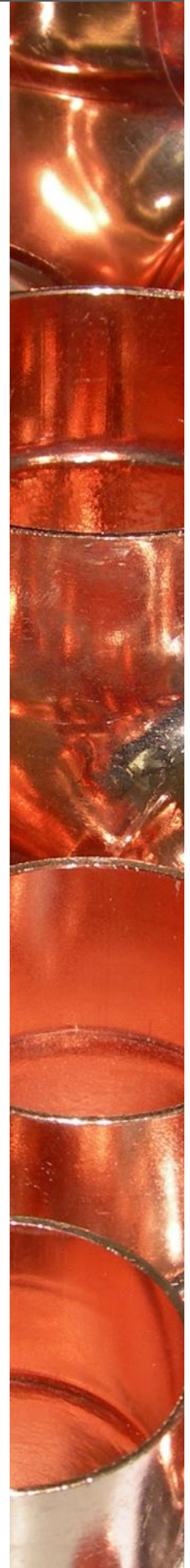
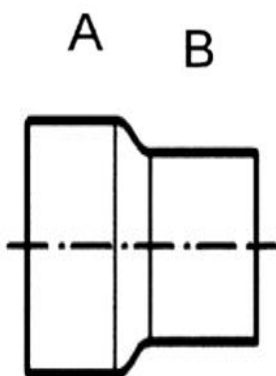
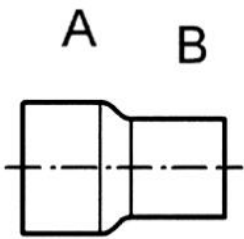

COPPER S TRAPS (CHROME OPTIONS)



S TRAPS WITH STANDARD INLET AND SHORT TAIL (+ TRAPS 65MM AND LARGER NON RETURNABLE)

SIZE	CODE	INLET 'M1'	TAIL 'L1'	CENTRES 'O'	OVERALL HEIGHT
25MM	STSCU25	165MM	165MM	62MM	190MM
32MM	STSCU32	175MM	175MM	74MM	202MM
40MM	STSCU40	175MM	175MM	80MM	202MM
50MM	STSCU50	230MM	230MM	120MM	235MM
65MM ⁺	STSCU65	290MM	290MM	156MM	300MM
80MM ⁺	STSCU80	405MM	405MM	220MM	470MM
100MM ⁺	STSCU100	550MM	550MM	275MM	660MM

S TRAPS WITH STANDARD INLET AND LONG TAIL

SIZE	CODE	INLET 'M1'	TAIL 'L2'	CENTRES 'O'	OVERALL HEIGHT
32MM	LTSCU32	175MM	580MM	74MM	610MM
40MM	LTSCU40	175MM	595MM	80MM	625MM
50MM	LTSCU50	230MM	635MM	120MM	595MM

S TRAPS WITH LONG INLET AND SHORT TAIL

SIZE	CODE	INLET 'M2'	TAIL 'L1'	CENTRES 'O'	OVERALL HEIGHT
32MM	LISTSCU32	305MM	175MM	74MM	340MM
40MM	LISTSCU40	325MM	175MM	80MM	350MM

S TRAPS WITH LONG INLET AND LONG TAIL

SIZE	CODE	INLET 'M2'	TAIL 'L2'	CENTRES 'O'	OVERALL HEIGHT
32MM	LILTSCU32	305MM	580MM	74MM	740MM
40MM	LILTSCU40	325MM	595MM	80MM	765MM

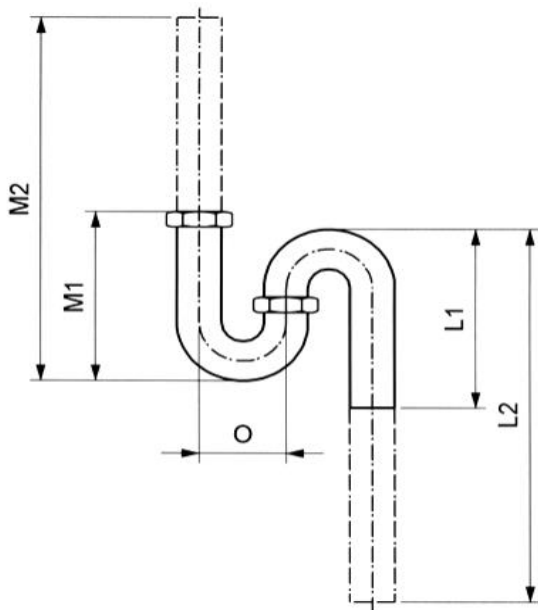

FOR CHROMED TRAPS SUBSTITUTE "CP" IN PLACE OF "CU" ALL CHROMED ITEMS FIRM SALE — NON RETURNABLE

COPPER P TRAPS (CHROME OPTIONS)

P TRAPS WITH STANDARD INLET AND SHORT TAIL (+ TRAPS 65MM AND LARGER NON RETURNABLE)

SIZE	CODE	INLET 'M1'	TAIL 'L1'	CENTRES 'O'
25MM	STPCU25	165MM	215MM	62MM
32MM	STPCU32	175MM	225MM	74MM
40MM	STPCU40	175MM	240MM	80MM
50MM	STPCU50	230MM	300MM	120MM
65MM ⁺	STPCU65	290MM	390MM	156MM
80MM ⁺	STPCU80	405MM	550MM	220MM
100MM ⁺	STPCU100	550MM	590MM	275MM

P TRAPS WITH STANDARD INLET AND LONG TAIL

SIZE	CODE	INLET 'M1'	TAIL 'L2'	CENTRES 'O'
32MM	LTPCU32	175MM	580MM	74MM
40MM	LTPCU40	175MM	595MM	80MM
50MM	LTPCU50	230MM	635MM	120MM

P TRAPS WITH LONG INLET AND SHORT TAIL

SIZE	CODE	INLET 'M2'	TAIL 'L1'	CENTRES 'O'
32MM	LISTPCU32	305MM	225MM	74MM
40MM	LISTPCU40	325MM	240MM	80MM

P TRAPS WITH LONG INLET AND LONG TAIL

SIZE	CODE	INLET 'M2'	TAIL 'L2'	CENTRES 'O'
32MM	LILTPCU32	305MM	580MM	74MM
40MM	LILTPCU40	325MM	595MM	80MM

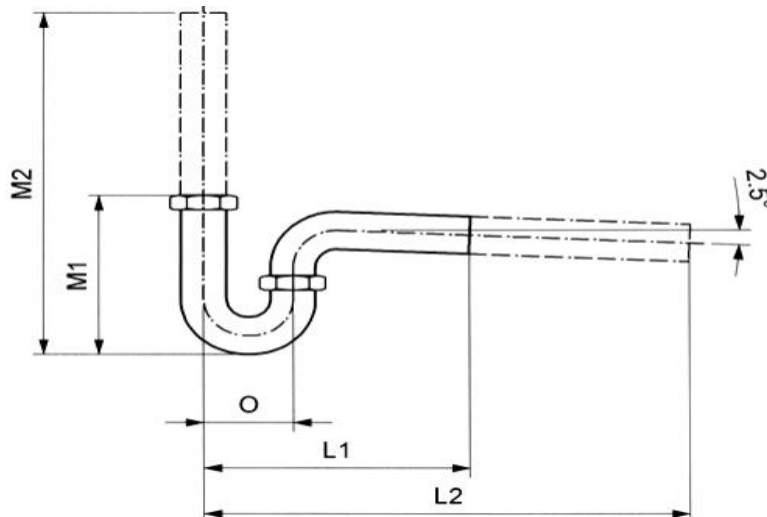

CHROMED TRAPS SUBSTITUTE "CP" IN PLACE OF "CU" ALL CHROMED ITEMS NON RETURNABLE

TRAP ACCESSORIES



CHROME TRAP EXTENSION—750MM LONG WITH BSP THREAD

SIZE	CODE	LENGTH 'L'
32MM	TECP32	750MM
40MM	TECP40	750MM
50MM	TECP50	750MM

CHROMED ITEMS NON RETURNABLE

LOOSE NUT AVAILABLE SEPARATELY

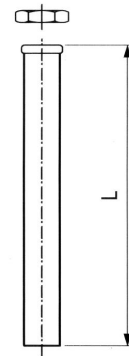

COPPER TUNDISHES

CODE	TRAP MATCH	RECEPTACLE SIZE
CUTUN32	32MM	65MM
CUTUN40	40MM	80MM
CUTUN50	50MM	100MM

CHROME PLATED ON REQUEST

LOOSE NUT AVAILABLE SEPARATELY

OTHER SIZES AVAILABLE ON REQUEST

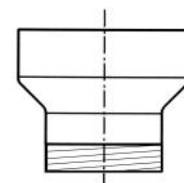

BRASS CAP (TRAP) NUTS

SIZE	CODE	BSP
32MM	CNCU32	1¼"
40MM	CNCU40	1½"
50MM	CNCU50	2"
65MM	CNCU65	2½"
80MM	CNCU80	3"
100MM	CNCU100	4"

STEPPED BRAZING RINGS ALSO AVAILABLE—PLEASE CALL



CHROME PLATED BRASS CAP (TRAP) NUTS

SIZE	CODE	BSP
32MM	CNCP32	1¼"
40MM	CNCP40	1½"
50MM	CNCP50	2"
65MM	CNCP65	2½"
80MM	CNCP80	3"
100MM	CNCP100	4"

CHROMED ITEMS NON RETURNABLE



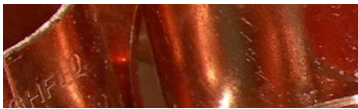

COPPER MATE FLANGES BY CTS™

TABLE D FLANGES (NOT COMPLIANT AS TABLE E)

SIZE	CODE	PCD
100MM	CF100T/D	178MM
150MM	CF150T/D	235MM

TABLE E FLANGES (COMPLIANT AS TABLE D AS NOTED)

SIZE	CODE	PCD	TABLE D	OPT. GASKET
25MM	CF25	83MM	NO	CF25FG
32MM	CF32	87MM	YES	CF32FG
40MM	CF40	98MM	YES	CF40FG
50MM	CF50	114MM	YES	CF50FG
65MM	CF65	127MM	YES	CF65FG
80MM	CF80	146MM	YES	CF80FG
100MM	CF100	178MM	NO	CF100FG
125MM~	CF125	210MM	YES	
150MM	CF150	235MM	NO	CF150FG
200MM~	CF200	292MM	NO	CF200FG

~SUITS AS1432 TUBE

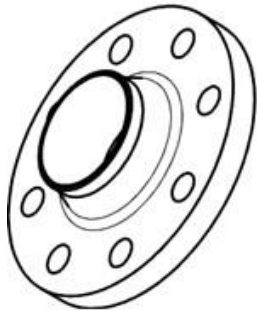

DIN (PN16) FLANGES

SIZE	CODE	PCD	OPT. GASKET
25MM	CF25PN16	85MM	
32MM	CF32PN16	100MM	CF32PN16FG
40MM	CF40PN16	110MM	CF40PN16FG
50MM	CF50PN16	125MM	CF50PN16FG
65MM	CF65PN16	145MM	CF65PN16FG
80MM	CF80PN16	160MM	CF80PN16FG
100MM	CF100PN16	180MM	CF100PN16FG
125MM~	CF125PN16	210MM	
150MM	CF150PN16	240MM	CF150PN16FG
200MM~	CF200PN16	295MM	

~SUITS AS1432 TUBE

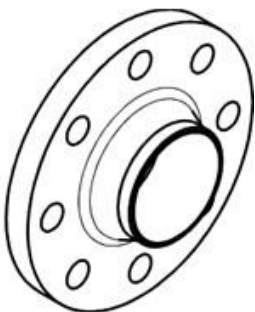

ANSI 150 FLANGES *REMAINING STOCK ONLY

SIZE	CODE	PCD	OPT. GASKET
50MM	CF50ANSI150	120.5MM	CF50ANSI150FG
65MM	CF65ANSI150	139.5MM	CF65ANSI150FG
80MM	CF80ANSI150	152.5MM	CF80ANSI150FG
100MM	CF100ANSI150	190.5MM	CF100ANSI150FG

TABLE E BLIND FLANGES *REMAINING STOCK ONLY

SIZE	CODE	PCD	TABLE D	OPT. GASKET
50MM	BBF50	114MM	YES	CF50FG
65MM	BBF65	127MM	YES	CF65FG
80MM	BBF80	146MM	YES	CF80FG
100MM	BBF100	178MM	NO	CF100FG
150MM	BBF150	235MM	NO	CF150FG
200MM	BBF200	292MM	NO	CF200FG

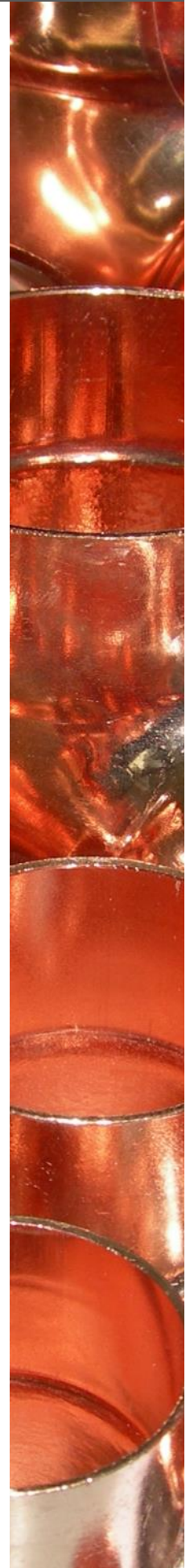
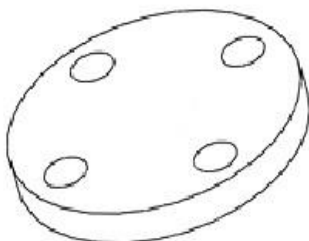

JUNCTIONS AT 45°



EQUAL JUNCTIONS

CODE	TOP (FEMALE)	BOTTOM (MALE)	BRANCH (FEMALE)
C45J32	32MM	32MM	32MM
C45J40	40MM	40MM	40MM
C45J50	50MM	50MM	50MM
C45J65	65MM	65MM	65MM
C45J80	80MM	80MM	80MM
C45J100	100MM	100MM	100MM

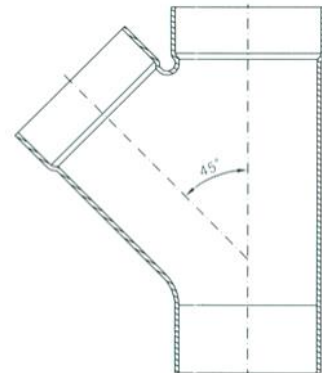

REDUCING JUNCTION COMBOS (JUNCTIONS AND REDUCERS)

JUNCTION	TOP (FEMALE)	BOTTOM (MALE)	BRANCH (FEMALE)
C45J32	32MM	32MM	32MM REDUCEABLE DOWN TO 25MM, 20MM OR 15MM.
C45J40	40MM	40MM	40MM REDUCEABLE DOWN TO 32MM, 25MM, 20MM OR 15MM.
C45J50	50MM	50MM	50MM REDUCEABLE DOWN TO 40MM, 32MM, 25MM OR 20MM.
C45J65	65MM	65MM	65MM REDUCEABLE DOWN TO 50MM, 40MM OR 32MM.
C45J80	80MM	80MM	80MM REDUCEABLE DOWN TO 65MM, 50MM OR 40MM.
C45J100	100MM	100MM	100MM REDUCEABLE DOWN TO 80MM, 65MM OR 50MM.

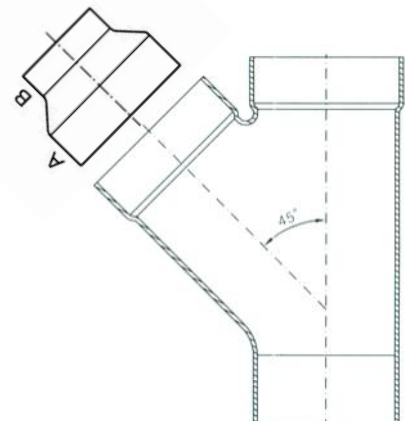

EQUAL JUNCTION COMBOS

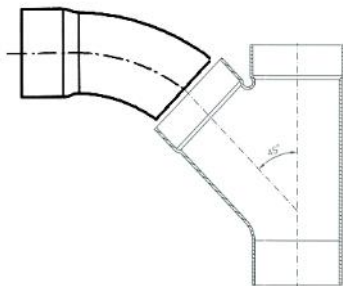

C45J32 JUNCTION COMBINED WITH A CB3245

C45J40 JUNCTION COMBINED WITH A CB4045

C45J50 JUNCTION COMBINED WITH A CB5045

C45J65 JUNCTION COMBINED WITH A CB6545

C45J80 JUNCTION COMBINED WITH A CB8045

C45J100 JUNCTION COMBINED WITH A CB10045

PLEASE ENQUIRE FOR FULL DETAILS AND OTHER COMBINATIONS

REDUCING JUNCTION COMBOS

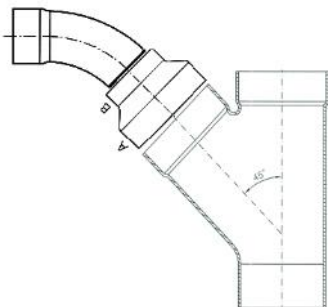

C45J32 JUNCTION COMBINED WITH A 45° FITTING AND REDUCERS
TO TAKE BRANCH DOWN TO 25MM, 20MM OR 15MM

C45J40 JUNCTION COMBINED WITH A 45° FITTING AND REDUCERS
TO TAKE BRANCH DOWN TO 32MM, 25MM, 20MM OR 15MM

C45J50 JUNCTION COMBINED WITH A 45° FITTING AND REDUCERS
TO TAKE BRANCH DOWN TO 40MM, 32MM, 25MM OR 20MM

C45J65 JUNCTION COMBINED WITH A 45° FITTING AND REDUCERS
TO TAKE BRANCH DOWN TO 50MM, 40MM OR 32MM

C45J80 JUNCTION COMBINED WITH A 45° FITTING AND REDUCERS
TO TAKE BRANCH DOWN TO 65MM, 50MM OR 40MM

C45J100 JUNCTION COMBINED WITH A 45° FITTING AND REDUCERS
TO TAKE BRANCH DOWN TO 80MM, 65MM OR 50MM

PLEASE ENQUIRE FOR FULL DETAILS AND OTHER COMBINATIONS.

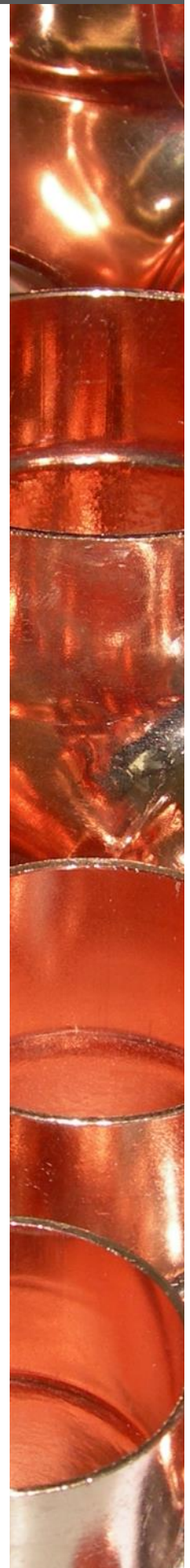

MISCELLANEOUS

TUBE JOINERS

SIZE CODE

10MM* TJ10

*SUITS 9.52MM AS/NZS1571 TUBE

15MM TJ15

20MM TJ20

25MM TJ25

32MM TJ32

40MM TJ40

50MM TJ50

65MM TJ65

80MM TJ80

100MM TJ100

125MM^ TJ125

^NO LONGER SUPPORTING AS3688—REMAINING STOCK ONLY

150MM TJ150

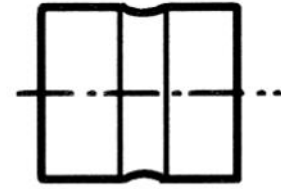

END CAPS

SIZE CODE

15MM CC15

20MM CC20

25MM CC25

32MM CC32

40MM CC40

50MM CC50

65MM CC65

80MM CC80

100MM CC100

125MM CC125 (NZ)

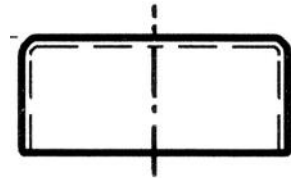

COPPER FLUSHPIPES

SIZE CODE LENGTH 'L' LENGTH 'O'

40MM FPCU4062 600MM 200MM

40MM FPCU40753 750MM 300MM

50MM FPCU5062 600MM 200MM

CHROME FLUSHPIPES

SIZE CODE LENGTH 'L' LENGTH 'O'

40MM FPCP4052 500MM 200MM

40MM FPCP4062 600MM 200MM

40MM FPCP40753 750MM 300MM

50MM FPCP5062 600MM 200MM

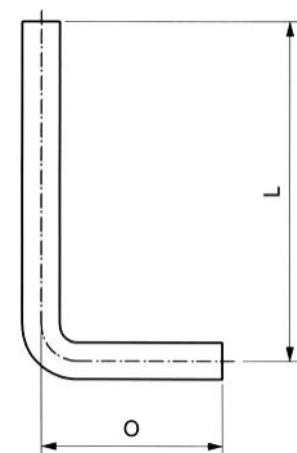

NZ (NZS3501) TO AUSTRALIAN (AS1432) TUBE (ADAPTOR) JOINERS

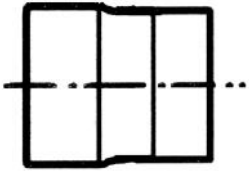

SIZE	CODE	TO JOIN
15MM	TA15	15MM NZ TO 1/2" (15MM) AUST (F/F FITMENT)
20MM	TA20	20MM NZ TO 3/4" (20MM) AUST (F/F FITMENT)
25MM	TA25	25MM NZ TO 1" (25MM) AUST (F/F FITMENT)
32MM	TA32	32MM NZ TO 1 1/4" (32MM) AUST (F/F FITMENT)
40MM	TA40	40MM NZ TO 1 1/2" (40MM) AUST (F/F FITMENT)
50MM	TA50	50MM NZ TO 2" (50MM) AUST (F/F FITMENT)
65MM	TA65	65MM NZ TO 2 1/2" (65MM) AUST (F/F FITMENT)
80MM	TA80	80MM NZ TO 3" (80MM) AUST (F/F FITMENT)
100MM	TA100	100MM NZ TO 4" (100MM) AUST (F/F FITMENT)

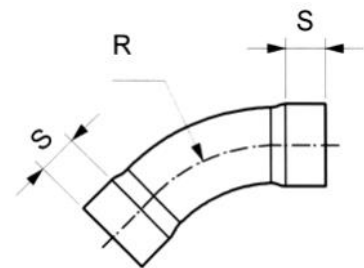
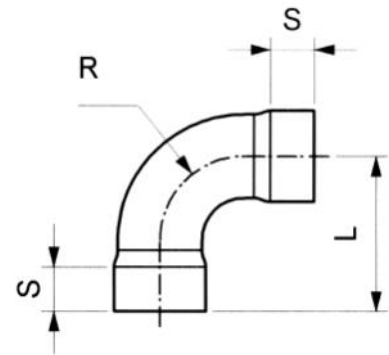

TABLE I COMPLIANT FITTINGS



FITTINGS BELOW CAN BE CUSTOM ORDERED AS TABLE I COMPLIANT (COPPER COMPOSITION, GAUGE AND SOCKETS)

SIZE	CODE	DESCRIPTION
80mm	CE8090	80mm x 90° Copper Elbow
80mm	CE8045	80mm x 45° Copper Elbow
80mm	CTE80	80mm Equal Tee
80mm	CR8040	80mm x 40mm Single Step Reducer
80mm	CR8050	80mm x 50mm Single Step Reducer
80mm	CR8065	80mm x 65mm Single Step Reducer
80mm	CTR808040	80mm x 80mm x 40mm Reducing Tee
80mm	CTR808050	80mm x 80mm x 50mm Reducing Tee
80mm	CTR808065	80mm x 80mm x 65mm Reducing Tee
80mm	C45J80	80mm Y Junction at 45°
80mm	CF80	80mm Table E Flange
80mm	CF80PN16	80mm PN16 Flange
80mm	CF80ANSI150	80mm ANSI150 Flange



SIZE	CODE	DESCRIPTION
100mm	CE10090	100mm x 90° Copper Elbow
100mm	CE10045	100mm x 45° Copper Elbow
100mm	CTE100	100mm Equal Tee
100mm	CR10050	100mm x 50mm Single Step Reducer
100mm	CR10065	100mm x 65mm Single Step Reducer
100mm	CR10080	100mm x 80mm Single Step Reducer
100mm	CTR10010050	100mm x 100mm x 50mm Reducing Tee
100mm	CTR10010065	100mm x 100mm x 65mm Reducing Tee
100mm	CTR10010080	100mm x 100mm x 80mm Reducing Tee
100mm	C45J100	100mm Y Junction at 45°
100mm	CF100T/D	100mm Table D Flange
100mm	CF100	100mm Table E Flange
100mm	CF100PN16	100mm PN16 Flange
100mm	CF100ANSI150	100mm ANSI150 Flange

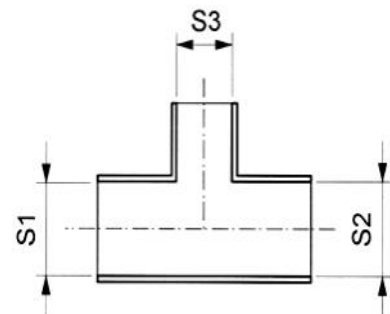

A B

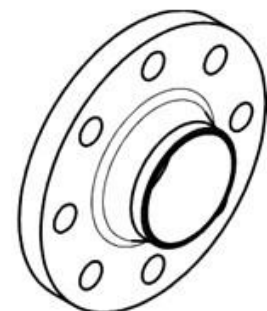
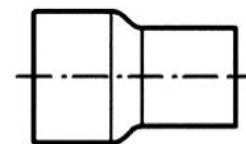

PLEASE CALL REGARDING LEAD-TIMES AND CUSTOMISATION COSTS



COMPLIANCE STATEMENT



Without compromise, every fitting sold by Highflo Company meets or exceeds the specifications for Copper Tube as detailed by NZS3501, or its nearest comparable international standard.

New Zealand does not have a specific Standard's Document dedicated to Copper Plumbing Fittings, rather they are 'associated' with NZS3501 which is not ideal as it's not specifically written to incorporate Copper Fittings. Therefore Highflo ensures supply of fit for purpose Copper Fittings by adherence to the undertakings as detailed below:

Currently, all mother tube that we bend in New Zealand, is from Nungwon Korea. Certification and compliance documentation to NZS3501 standard is available upon request.

Should you have a brand of tube, or a country of origin requirement for the tube your fittings are manufactured from, this can often be accommodated.

Every New Zealand made fitting is manufactured on a 'Fit for Purpose' production line. Internal forming is smooth, as per the requirements of the standard, to minimise flow turbulence. All sockets are engineered to an interference fit as per the relevant standards.

All fittings that we import from our partner factories are sample checked for compliance as below:

Stage I (Where Possible given the Covid situation) is an initial random sample check by a Highflo staff member at the factory of origin. This conformity check is completed before containerisation and is targeted at ensuring only compliant products are shipped. This also allows the opportunity for the partner factory to rectify any highlighted compliance issues before shipping.

Stage II is a further comprehensive check, of a much larger sample size, in our New Zealand warehouse. Checks include gauge verification, pressure testing, and occasionally X-Raying to ensure gauge conformity.

Stage III is a Copper Composition Test completed here in New Zealand, by an independent laboratory, on samples of our imported fittings, confirming compliance to Copper Composition as Alloy C12200 (DHP Copper). Compliance documentation is available upon request.

It is only once all testing comes back 'compliant' that fittings are released for sale.

Documentation confirming compliance of the NZS3501 tube we manufacture from on site, is also provided by our tube supplier and is available upon request.

Likewise a Brass Compliance test is also available for our Cap Nuts and Brazing Rings.

The Laser Marking of all Highflo Fittings for traceability, and showing continuity of fitting supply in an installation, is also currently being implemented across our entire range (except Chrome Plated Items which can't be marked owing to the reflective nature of the chrome finish).

If your installation or contract supply will only accept marked fittings, please make contact with us during this implementation period and discuss your requirements.



UNDERTAKINGS, TERMS AND CONDITIONS

Highflo's Dispatch Promise:

Highflo will endeavour to dispatch all orders on the same day as we receive the Purchase Order. Purchases are picked in the same order as they are received.

The preferred method of ordering is via Email to: sales@highflo.co.nz Telephone orders can be pre-picked based on the phone call, but will not be dispatched, until receipt of a Physical Order to verify that placed over the phone.

Should your order arrive late in the day we will still do our very best to get it on its way to you the same day. Feel free to give us a call should your order be extremely urgent and you want to confirm its ETA. This undertaking excludes all Made to Order Products.

Purchase Order Numbers:

Highflo can only process orders upon physical receipt of a valid Purchase Order Number. Temporary or Interim numbers can not be accepted.

Minimum Order Value (MOV):

It is Highflo's requirement that all purchase orders meet a minimum price threshold of \$100. This value permits the economic cost of Picking and Packing, Invoicing, Issuing Statements and Reconciling Payment. The cost apportioned to freight is not included in the \$100 Minimum Order Value composition. If the MOV requirement can not be met in the first instance, we'd welcome your phone call to discuss what other items we can supply, to bring your order up to the minimum stipulated value. Orders under MOV will be delayed whilst we attempt to contact you to remedy the situation, so your understanding in advance is appreciated.

Delivery — Free Into Store (FIS) or Chargeable:

Most purchases over \$400, noting the exceptions below, are dispatched Free Into Store (FIS) and in most circumstances, are sent via NZ Couriers. This is a 'Next Business Day' service. Please note that the courier service isn't perfect 100% of the time, and delays do happen. Highflo suggests reliance on an overnight service is not advisable. Palletised Freight, Heavy Items and some SI locations are sent via alternate carriers and at minimum an additional day of transit should be allowed for.

Freight charges are to the customer's account for all purchases under \$400 and are charged according to the freight service used. If your order is below \$400 we strongly suggest calling in advance, and getting a freight value, and showing this on your Purchase Order before submitting.

Pick Up by Plumber or End User:

Where a Local Merchant directs a Plumber to collect their purchase directly from Highflo, and The Merchant requires the Packing Slip to be forwarded to them independently, a Packing Slip Forwarding Fee (PSFF) will be applied to the Invoice to cover the cost associated with scanning and emailing the paperwork, rather than just supplying with the order upon collection.

Dimensional Variation:

Many measurements within this catalogue are subject to manufacturing tolerances and minor variation. Bend Radius and Tube Gauge are not subject to this variation. All fittings are to suit NZS3501 Copper Plumbing Tube unless specified otherwise.

Packing Slips, Invoices, Payment & Transfer of Title:

Packing Slips are not priced with the exception of showing freight when an order is below FIS. Invoices are issued shortly after dispatch, preferably electronically. Prices charged are those ruling at the date of dispatch. Where a price is in dispute, the onus is upon the customer to provide proof of variation by way of quotation evidence or alike. Without this confirmation, the price to be paid, will be that as invoiced. Payment falls due, in full, on the 20th of the month following invoice.

All Prices are GST Exclusive.

Overdue invoices risk being penalised by the removal of any discount / rebate / incentive offered and the Buyer will be liable for any / all penalties, collection charges and interest arrears.

Property in the goods, whether installed or not, does not pass to the buyer until the buyer has discharged all outstanding indebtedness to the seller whatsoever.

RETURNS POLICY



In circumstances such as a picking error, Highflo will validate any Merchant claim by referencing it's own documentation, and once confirmed Highflo is at fault, Highflo will rectify the picking error, and where necessary supply a Pre-Paid courier ticket to return any mis-picked items. We would appreciate picking errors being brought to our attention within 2 business days of receipt of the delivery at your premises.

Highflo appreciates that mistakes can be made during the ordering process, and subject to the conditions below, Highflo offers a 14 day, no questions asked, right of return for items ordered in error.

Highflo's Return Policy is designed to protect against genuine ordering mistakes and allow for easy correction. The Return Policy does not offer protection, nor possibility for return, where an end user has not completed due diligence on the jobsite and ordered erroneously, nor does it offer protection where an end user has over ordered to make use of volume discounts and then attempts to return the bulk of their order. Likewise it is not designed to offer protection against changes in an installation or system design.

Should merchants wish to offer an added level of returnability to their customers, then this would form part of the special relationship between the merchant and their customer. Merchants offering additional returnability should do so in the knowledge that Highflo will not accept returns beyond those stated in this policy.

Highflo simply asks that customers take care with their ordering requirements. Highflo has no ability to return items to our Tube Supplier once we have fabricated fittings therefore we must ensure we have a level of protection that prevents us becoming badly overstocked by returns.

Return Conditions:

A Return Authorisation Number (RAN), obtained by contacting Highflo in the first instance, must be shown on all returns. Customers will be reminded of the necessary paperwork and product requirements to complete a return at this time. Any unauthorised or incomplete returns will not be processed. Highflo will advise the sender of reason for a declined return, and the returned items will be held at Highflo until such time as the sender arranges Freight Forward Collection. If not claimed within 90 days, unauthorised returns will be scrapped in lieu of storage fees.

Examples of Items that would be declined credit;

Dents or damage to a fitting or Socket.

Partially complete or opened original packs.

Worksite debris or dust on fitting.

Permanent merchant stickers applied to fitting or packaging.

Damaged Packaging.

A 20% restocking fee, or a minimum charge of \$20, will be applied to all returns. Outgoing freight costs may also be recovered if Highflo paid those in the first instance.

Non-Returnable Items:

Returns aren't offered against every item we sell. There are exclusions as listed below:

Any item ordered on Indent.

Any Contract Offer with discount pricing linked to MOV's, MOQ's or suchlike.

All Chrome plated goods are deemed to be confirmed sale and are strictly non-returnable.

All Plain Copper Traps 65mm and above are deemed confirmed sale & strictly non returnable.

All Made to Order goods are confirmed sale (from placement of order) & strictly non returnable.

If you are unsure of any of the above please feel free to get in touch, before you order, to seek clarification.



WARRANTY STATEMENT

Highflo undertakes that all fittings supplied are suitable for use with the stated AS / NZS Copper Tube as indicated in the catalogue.

In the unexpected event of a fitting failure, Highflo or its appointed representative, must be given the opportunity to view the fitting 'in situ'.

Material, Manufacture, Installation & Application are all factors relating to the performance of our products.

Should a fitting manufacturing fault be determined as the point of failure, Highflo's liability will extend solely to the replacement of the failed fitting.



Life Flight
Community
Partner 2020

Life Flight
Community
partner 2021

Life Flight
Community
partner 2022

Life Flight
Community
partner 2023

HIGHFLO COPPER FITTINGS - PROUD SPONSORS OF LIFE FLIGHT TRUST SINCE 2005

